

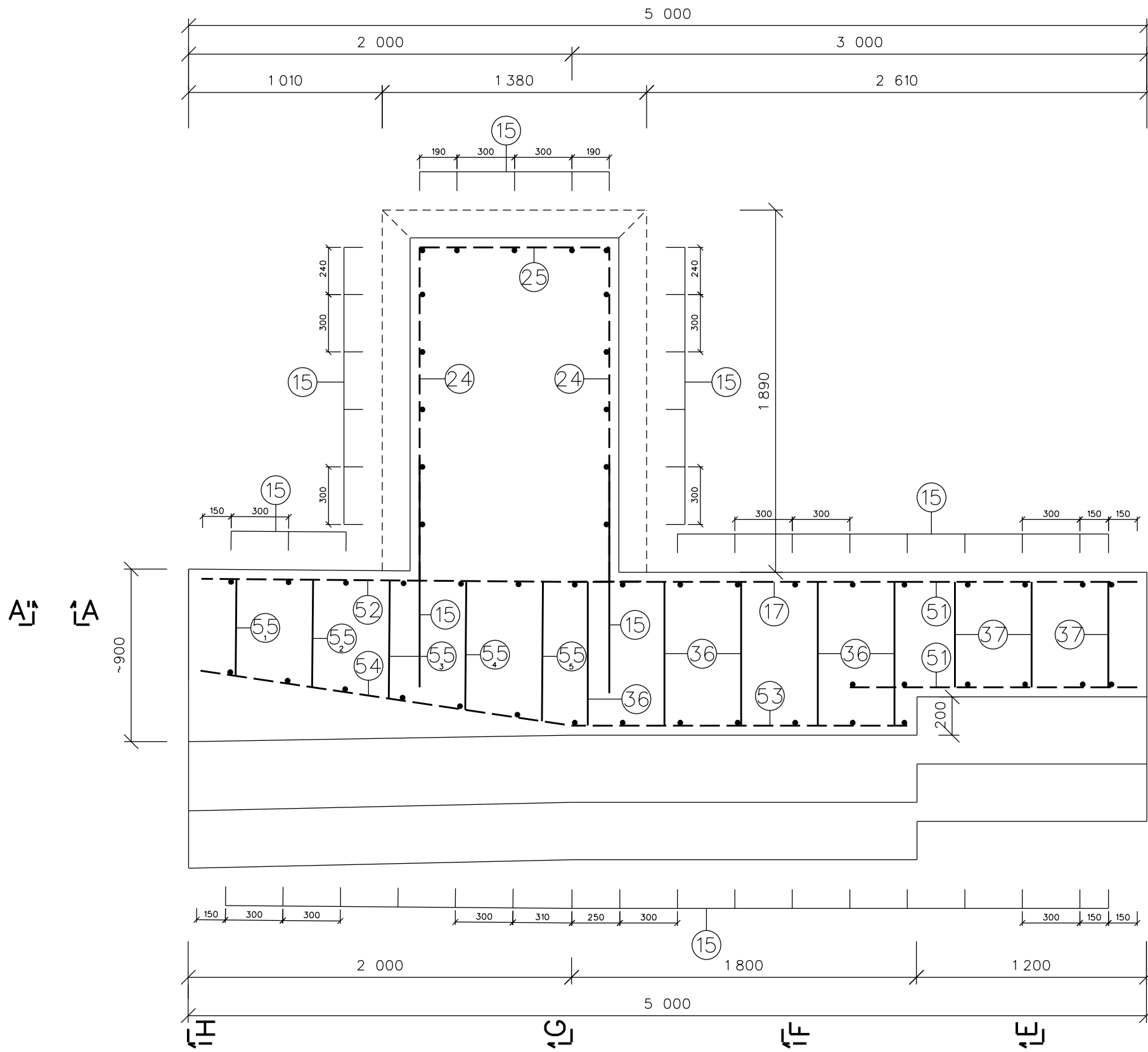

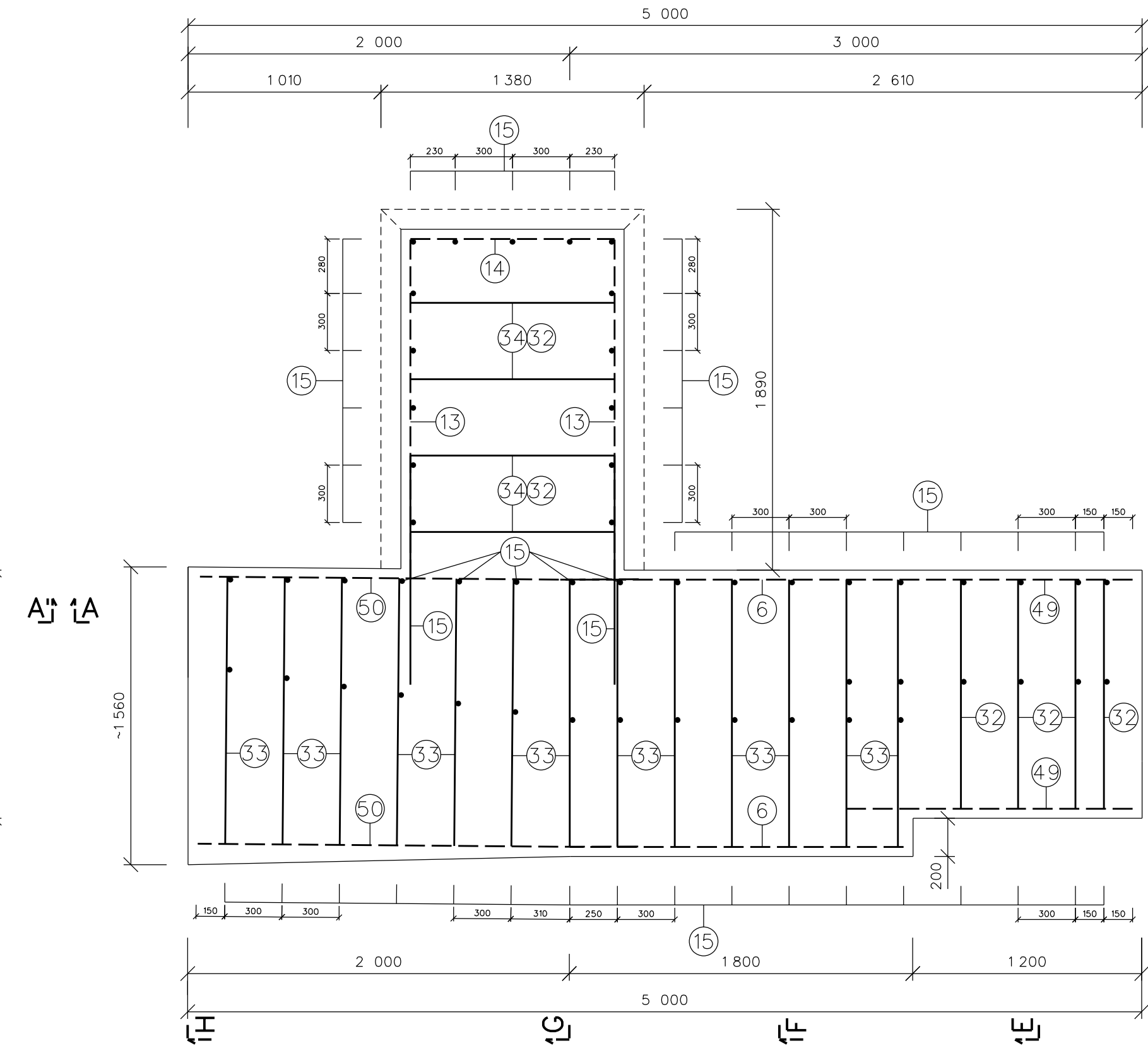

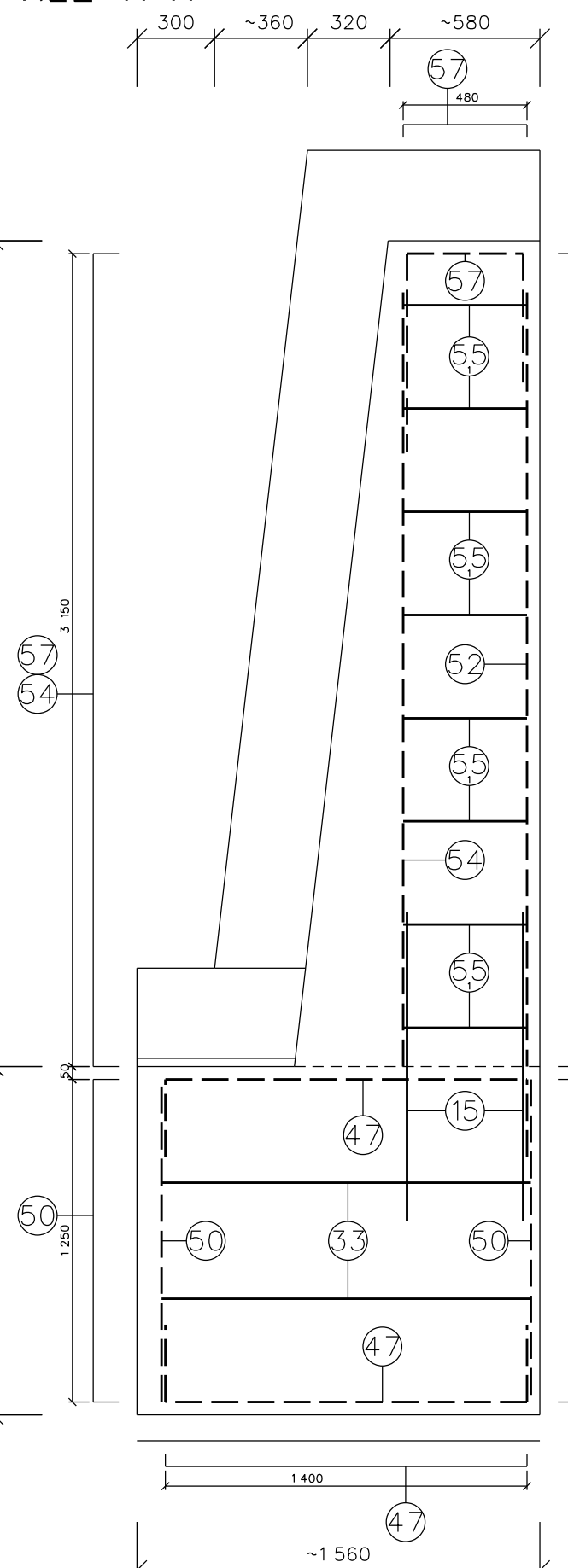

PODÉLNÝ ŘEZ A-A'

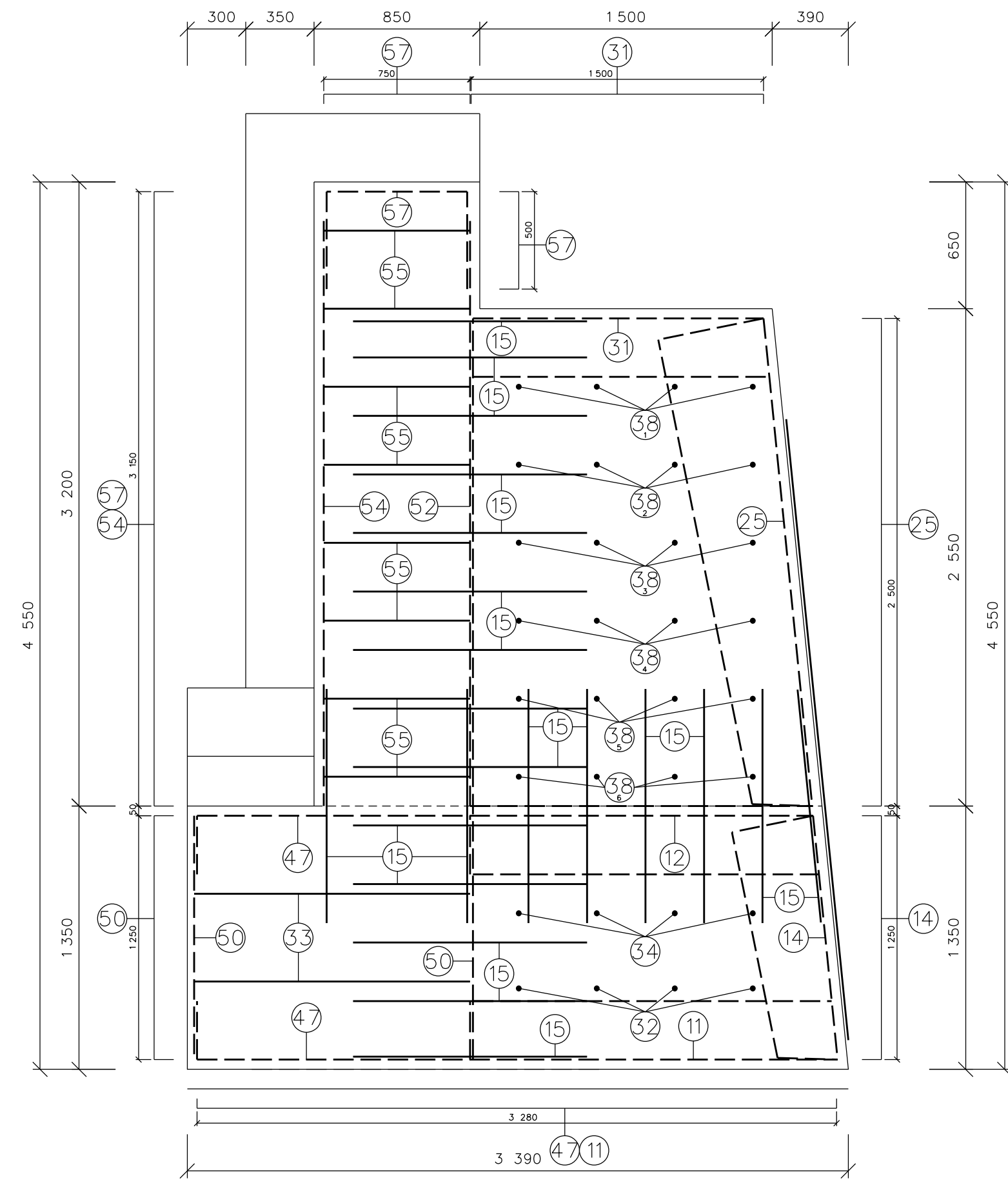
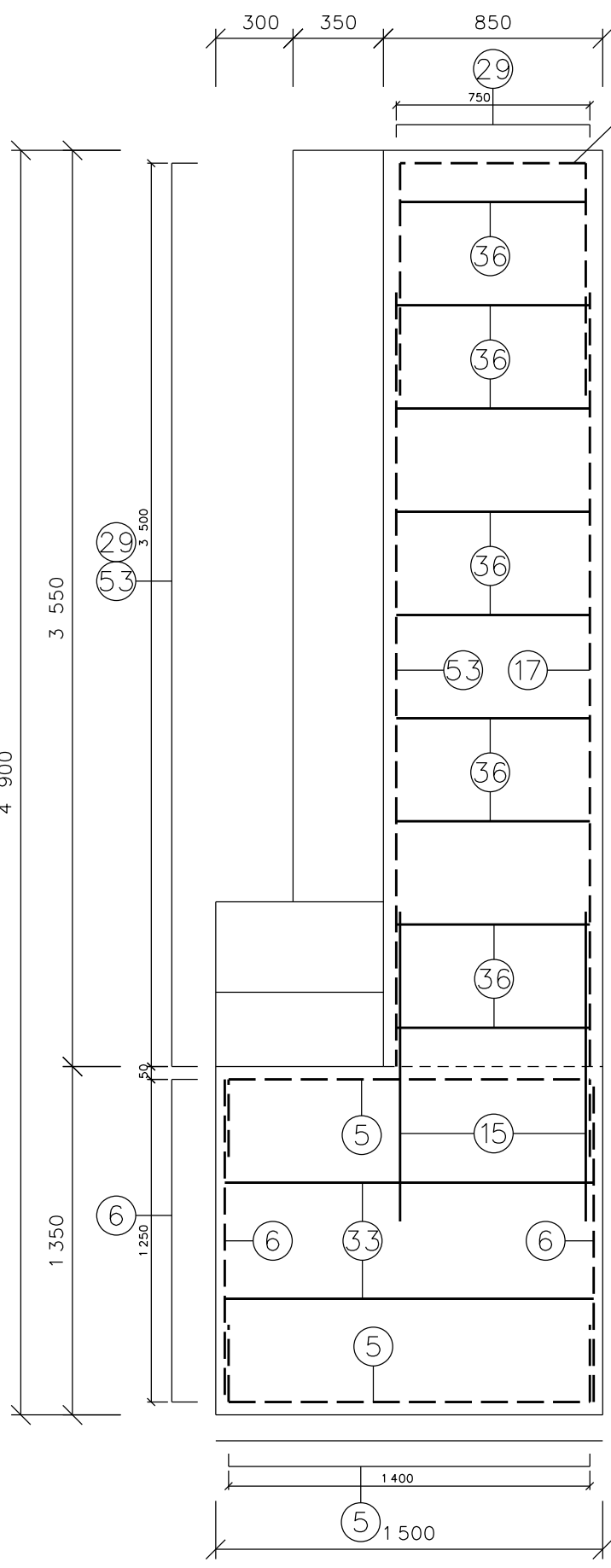
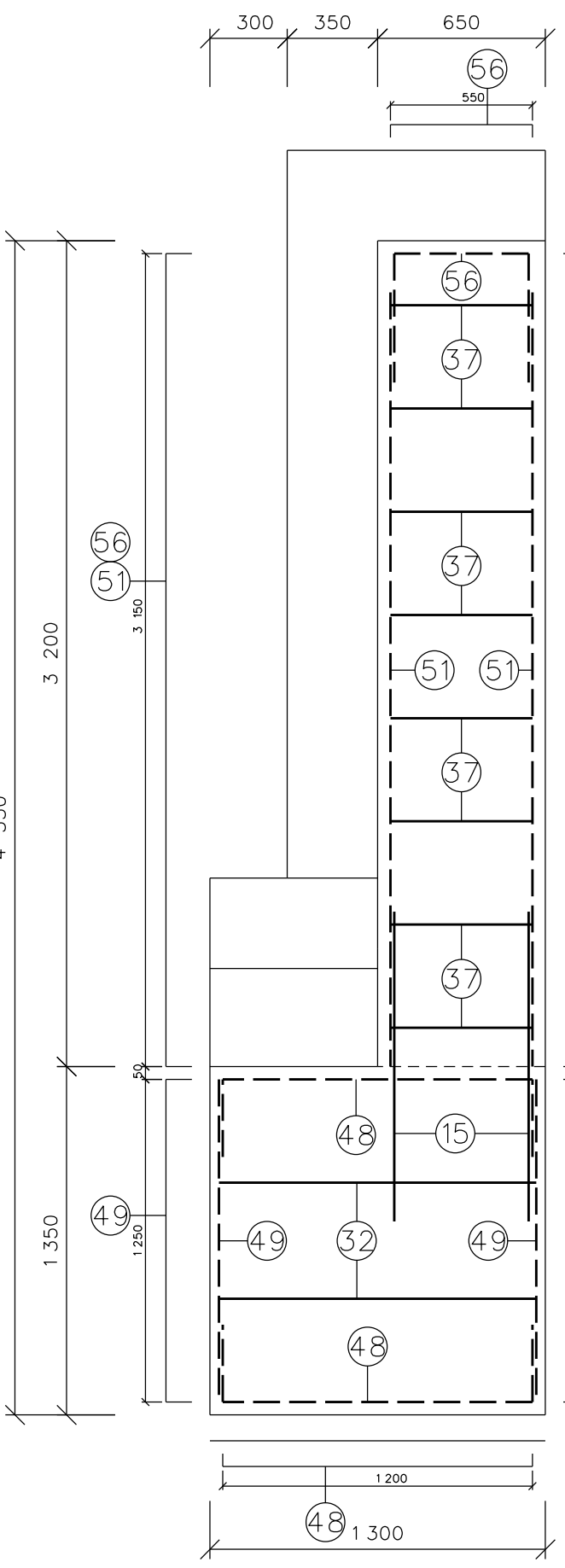
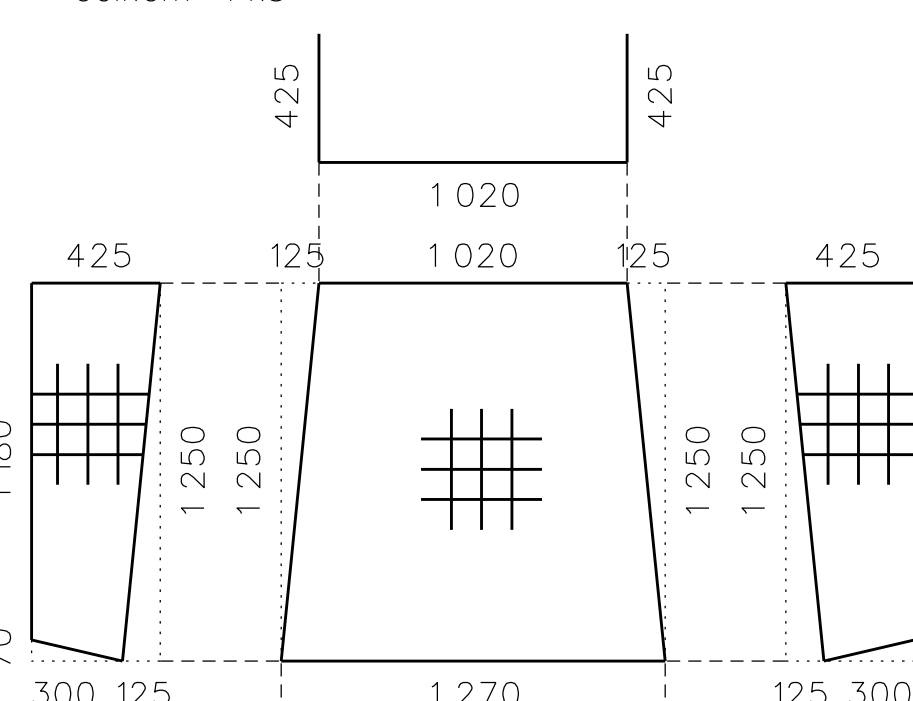
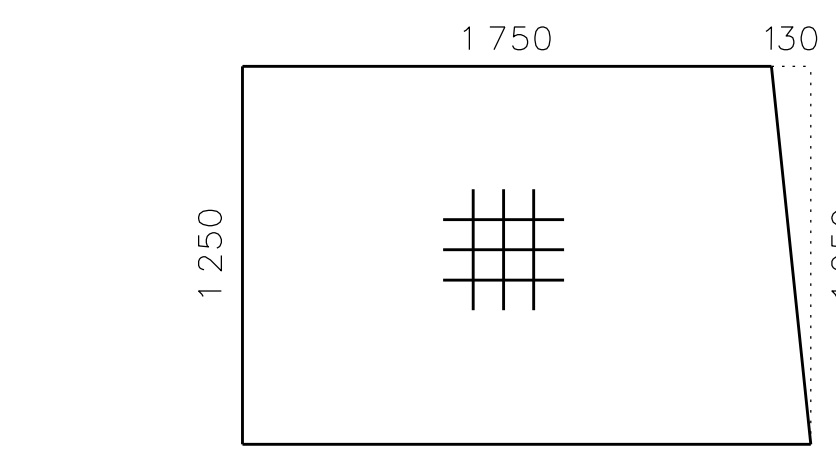
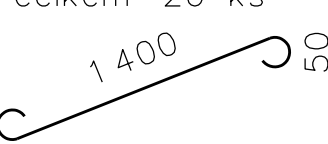
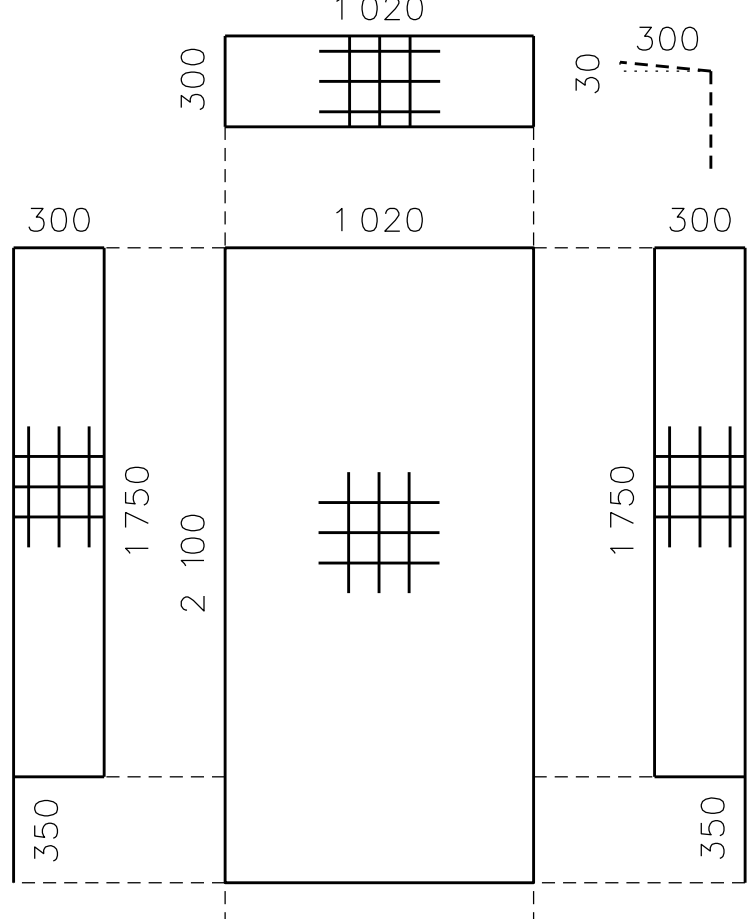
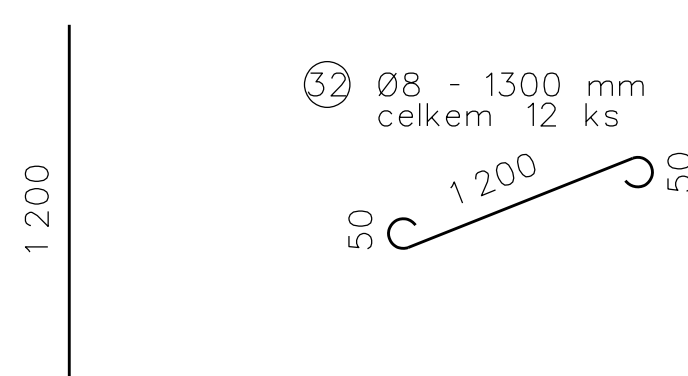
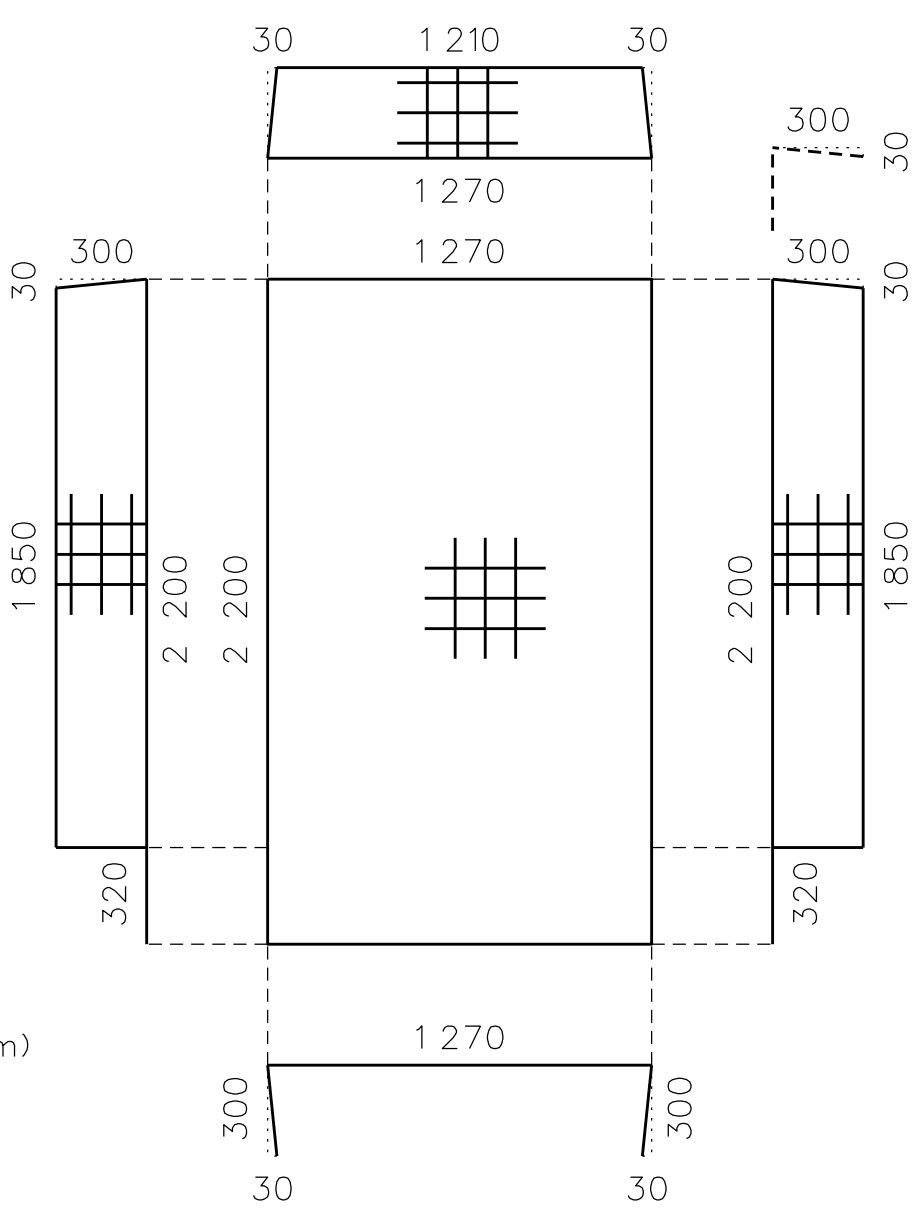
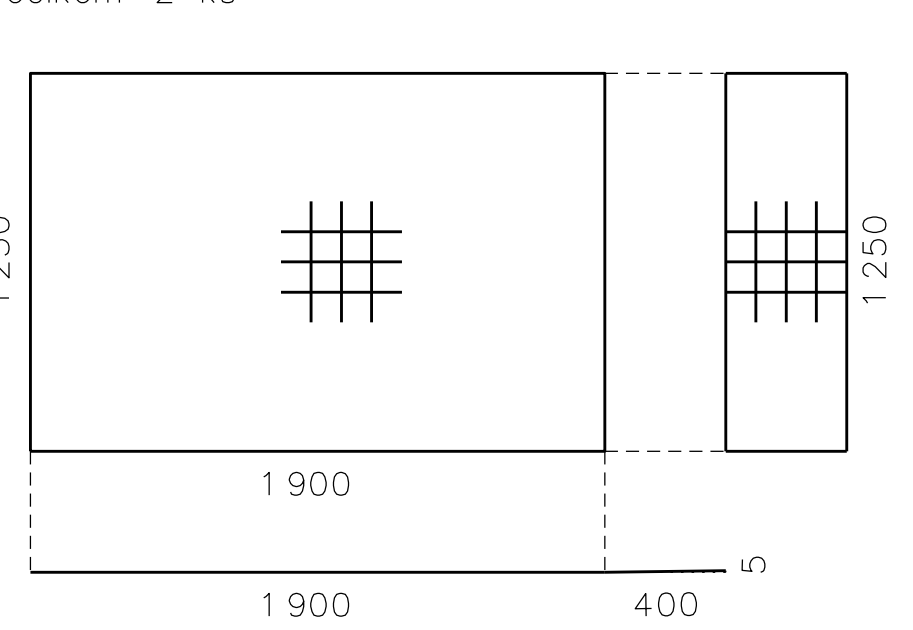
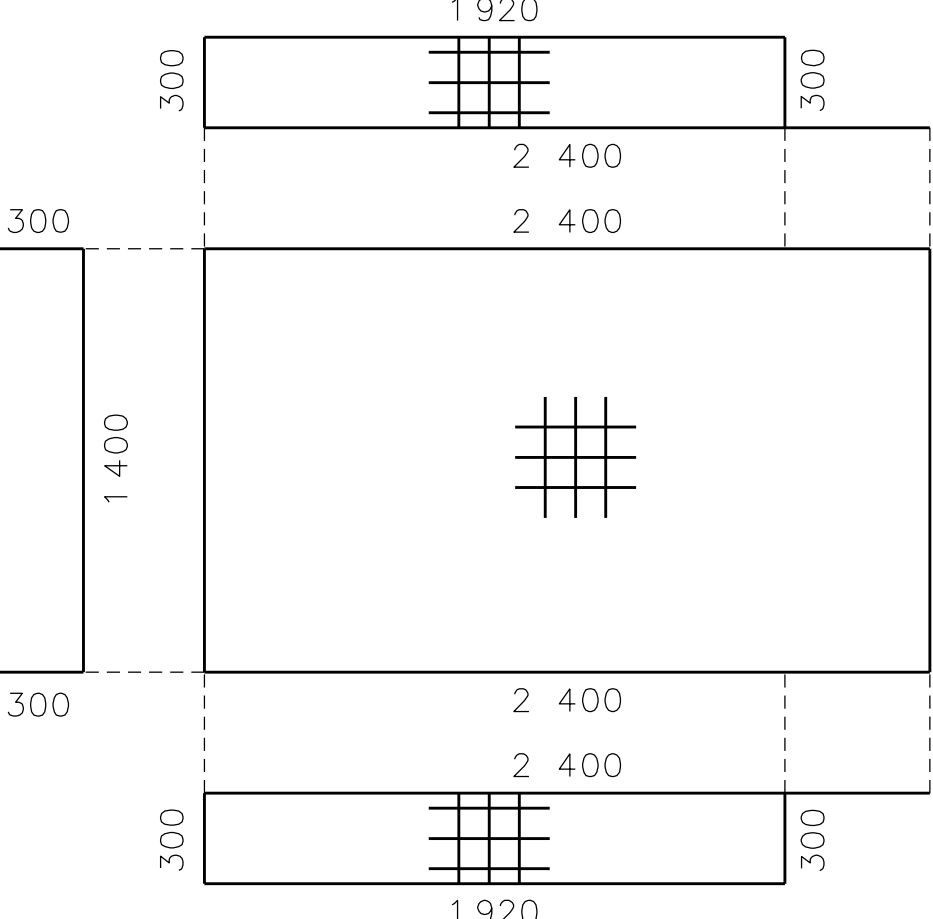
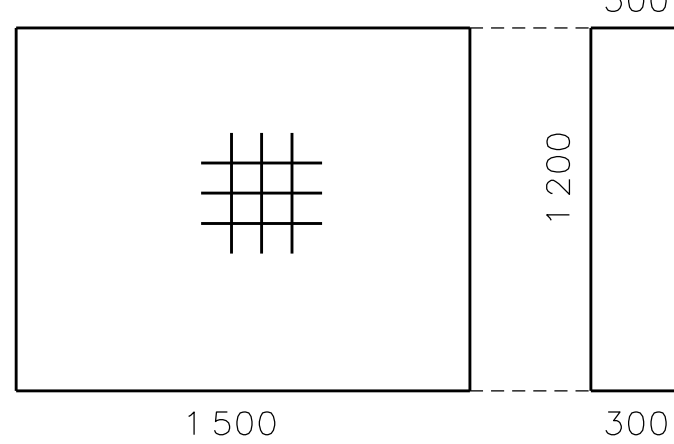
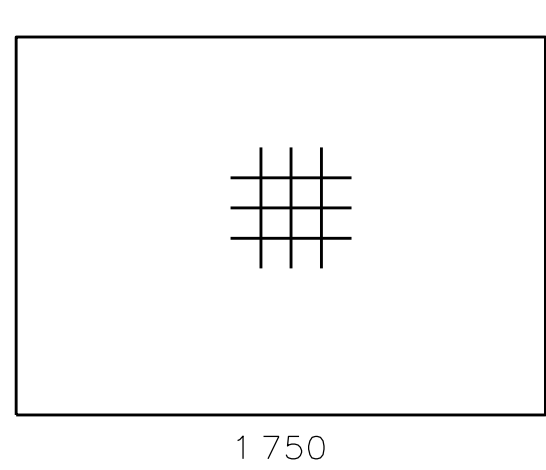
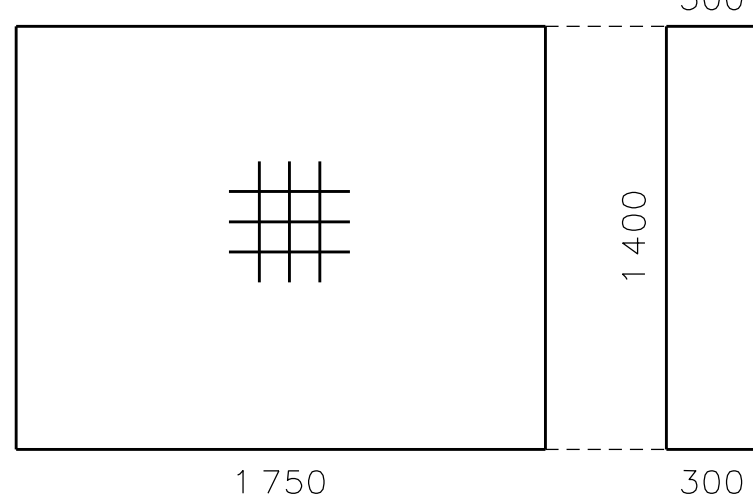
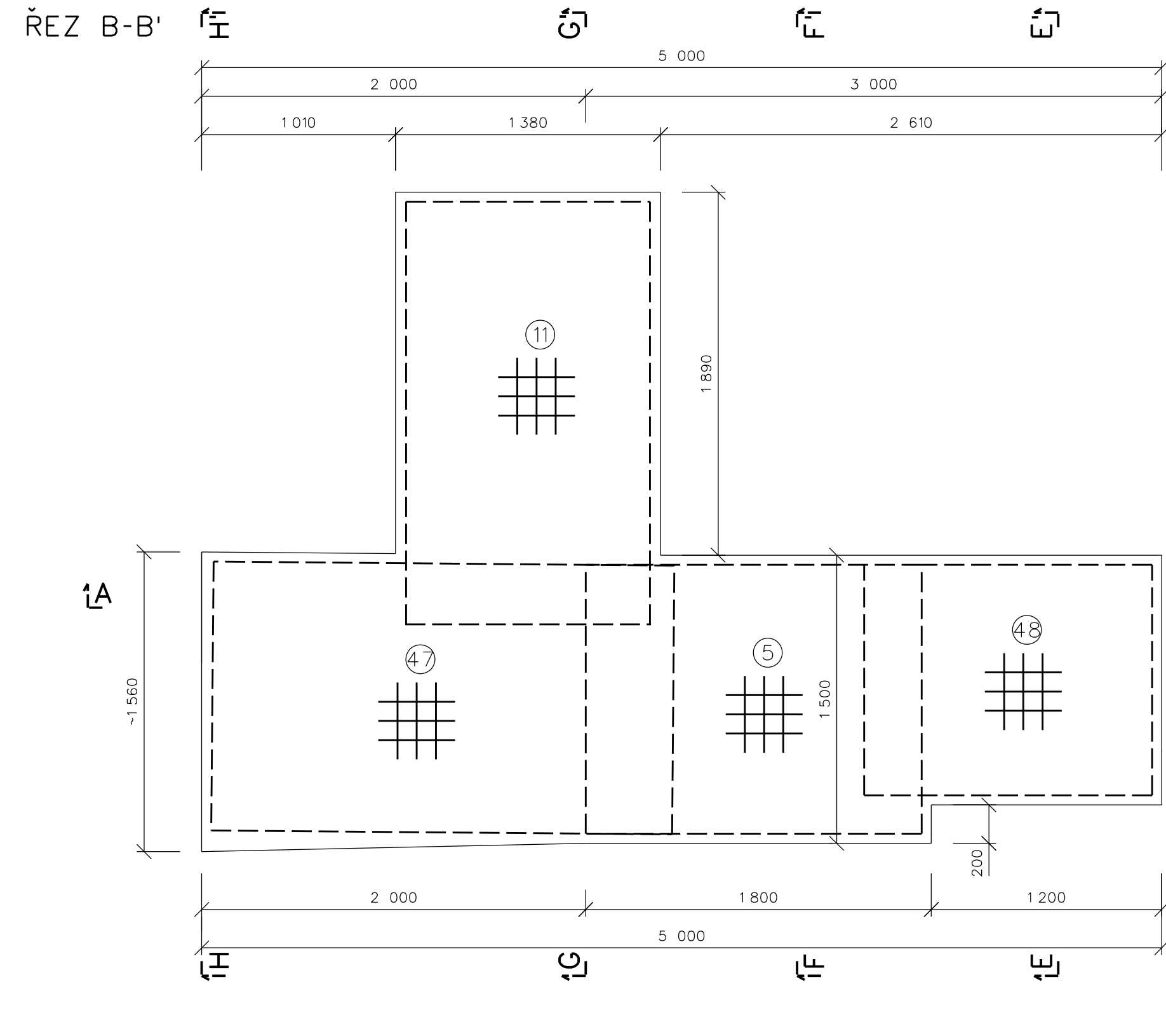
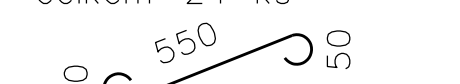
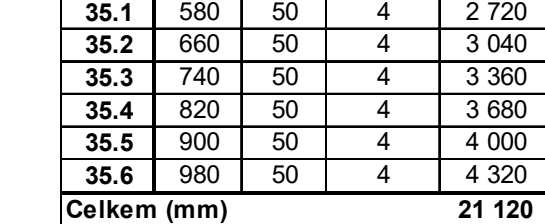
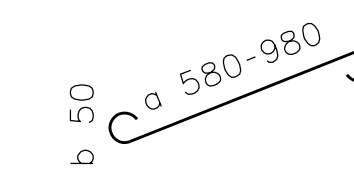
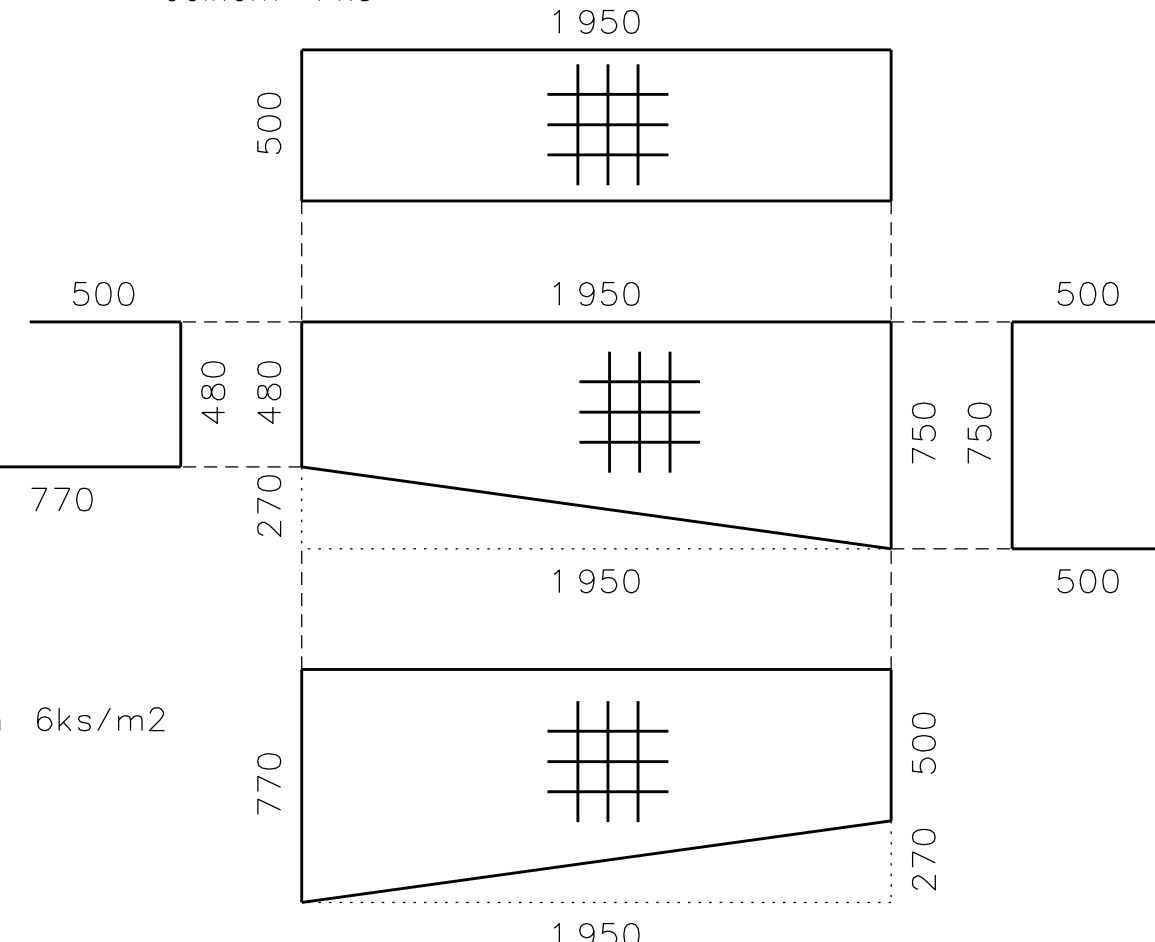
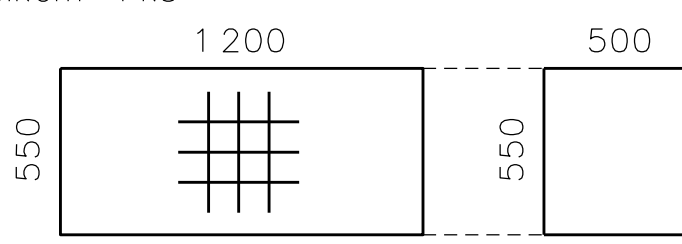
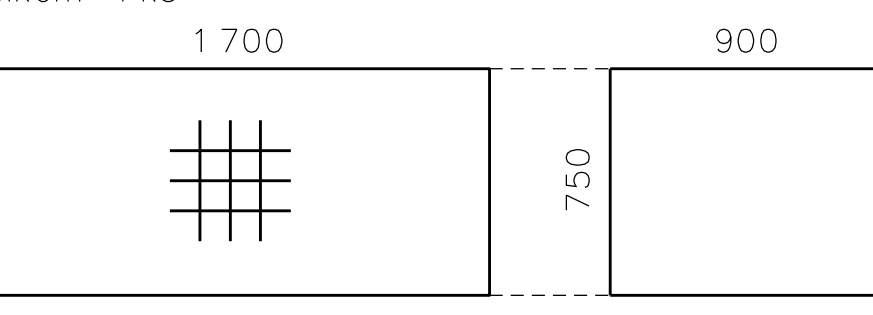
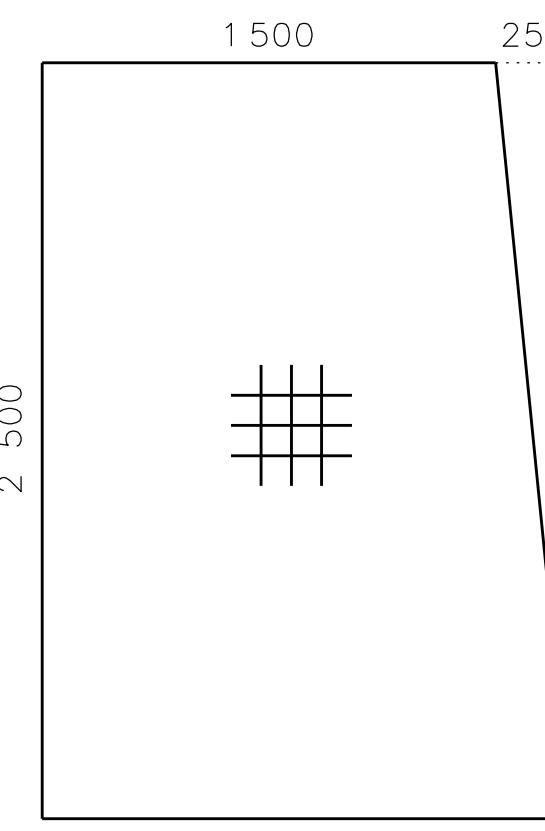
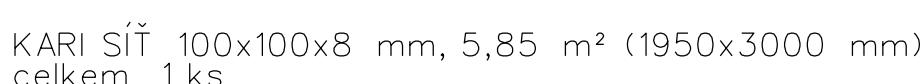
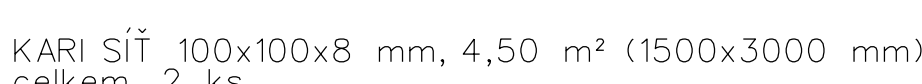

BLOK	OZN.	PRŮMĚR VÝŽIVĚ	DĚLKA	PLOCHA	KS	DĚLKA CELKEM		PLOCHA CELKEM	
						8	16	100x100x8	KARI
PRAMOBRZŮV ZED	5	100x100x8		3,50	2				7,00
	6	100x100x8		2,19	2				4,38
	11	100x100x8		4,28	1				4,28
	12	100x100x8		3,50	1				3,50
	13	100x100x8		2,27	2				4,54
	14	100x100x8		2,32	1				2,32
	15		1200	16	79		94,80		
	24	100x100x8		5,25	1				5,25
	24	100x100x8		4,06	2				8,12
	25	100x100x8		3,50	1				3,50
	29	100x100x8		4,34	1				4,34
	31	100x100x8		1,65	1				1,65
	32		8	1300	6	12	15,60		
	33		8	1500		26	39,00		
	34		8	1220		4	4,88		
	36		8	850		40	34,00		
	37		8	650		24	15,60		
	38		8	2120		1	21,12		
	47	100x100x8		4,51	2				9,02
	48	100x100x8		3,50	2				7,00
	49	100x100x8		1,88	2				3,76
	50	100x100x8		2,98	2				5,96
	51	100x100x8		4,50	2				9,00
	52	100x100x8		6,90	1				6,90
	53	100x100x8		6,30	1				6,30
54	100x100x8		5,85	1				5,85	
55		8	2840		1	28,64			
56	100x100x8		1,86	1				1,86	
57	100x100x8		2,41	1				2,41	
DĚLKA CELKEM (m) : PLOCHA CELKEM (m2)						159,84	94,80	198,22	
HMOTNOST (kg/m); (kg/m2)						0,400	1,580	7,900	
HMOTNOST (kg)						63,54	149,78	854,84	
HMOTNOST CELKEM (kg)						1 068,22			

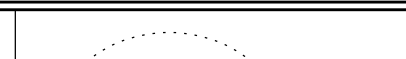
PŘEDPOKLÁDANÝ ROZMĚR KARI SÍTÍ
- 12ks 8/10/2,0x3,0m (KY 49)
- 1ks 8/10/2,15x5m (KY 81)
- 3ks 8/10/2,4x6m (AQ 80)
PŘELOŽENÍ SÍŤOVINY min. 300mm
KRYTÍ VÝZTUŽE 50mm

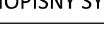

 vozovozoparation KODIFA A VESTERVA s.r.o. Nábřezka 1 150 5 Praha 5 02/61 01 00		VĚKOSOPRST-SYSTEM-BAV POLOHOPIRST-SYSTEM-S.JTŠK Verze			
Krevní Bc. Martin Šolák 	Odp. projektant Bc. Jakub Vojtěchovský, DiS. 	Techn. kontrola Ing. Miroslav Holeček 	Pure		
Vraj Ošestý 	Otec Bišany 	Šachov. D.2.10_význam_44_vzorok_zedn_dipn			
Ustavení Povodň. Ohře, státní podnik Bc. Bišany – jezové zdi a lávka – projektová dokumentace		Formát 18 x 4A Datum 08.02.2022 Úroveň DSP (+DDP) Cena 355 000 Měřítko 1:25 Č. výkresu D.2.10.			
Výkresová dokumentace					
Výzvat pravoběžní zed					